

# portland

1,340 SF  
[ 2 bedroom | 2 bath ]

# metrōlofts

URBAN LIVING IN THE WEST END

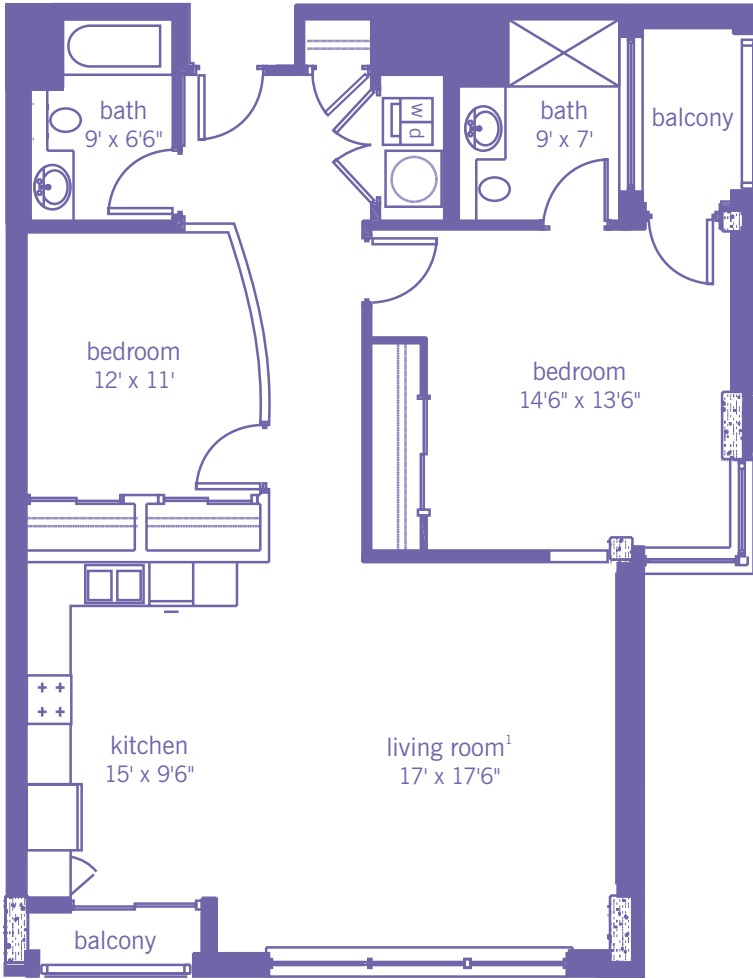

- full height walls
- 7 ft. wall height

\*patio per plan

<sup>1</sup>15' ceilings per plan

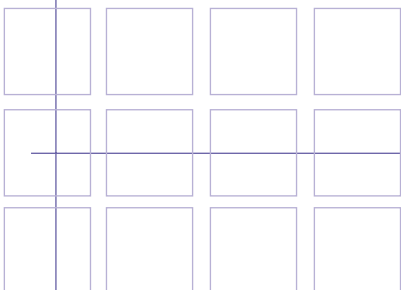

4535 FOREST PARK AVENUE  
ST LOUIS MISSOURI 63108  
P 314.367.2400 F 314.367.2479  
[www.metrolofts-stl.com](http://www.metrolofts-stl.com)