

euclid [2]

1,215 sF
[2 bedroom | 2 bath]

metrōlofts

URBAN LIVING IN THE WEST END

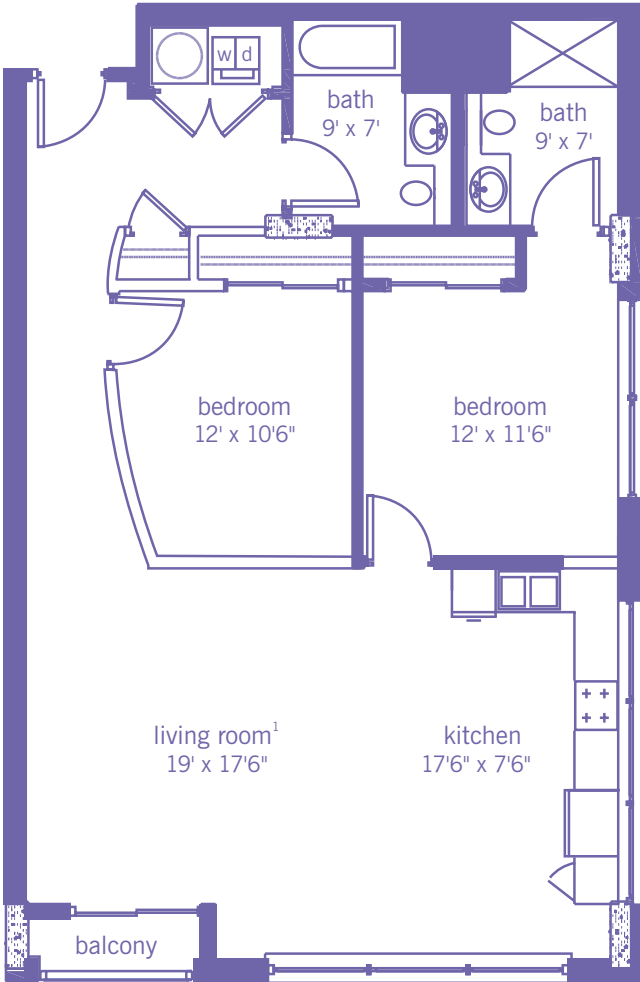

- full height walls
- 7 ft. wall height

*patio per plan

¹15' ceilings per plan

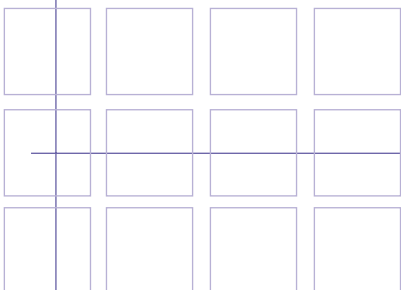

4535 FOREST PARK AVENUE
ST LOUIS MISSOURI 63108
P 314.367.2400 F 314.367.2479
www.metrolofts-stl.com